



# HILLPOINTE POINTE GRAND MARYVILLE

Revisors / Submitters  
Date

© 2024 CESO INC.  
Project Number: 767953-01  
Scale: AS SHOWN  
Drawn By: AJS  
Checked By: JJD  
Date: 02/13/2026

Drawing Title:  
**PLANTING PLAN**

**L1.0**

**LEGEND**

PROPERTY BOUNDARY LINE	---
EASEMENT LINE	---
OVERHEAD POWER LINE	---
STORM DRAIN	---
SANITARY SEWER	---
WATER LINE	---
GAS LINE	---
UNDERGROUND TELEPHONE LINE	---
UNDERGROUND ELECTRIC LINE	---
MAJOR EXISTING CONTOUR	---
MAJOR ENGINEERED CONTOUR	---
MINOR ENGINEERED CONTOUR	---
PROPOSED FENCE	---
CATCH BASIN	---
STORM MANHOLE	---
SANITARY MANHOLE	---
FIRE HYDRANT	---
RIGHT OF WAY LINE	---

**REQUIREMENTS PER ZONING REGULATIONS OF BLOUNT COUNTY**

**LANDSCAPE BUFFERS:**  
 10' BUFFER WITH 100% EVERGREEN OR 8" MINIMUM WIDE EVERGREEN HEDGE ALONG SIDE AND REAR OF THE PROPERTY LINE  
 40' BUFFER WITH 100% MULCH OR 10" WIDE LANDSCAPE BUFFER ALONG FRONT AND SIDE OF THE PROPERTY LINE  
 150' TRANSMISSION LINE EASEMENT REQUIRED  
 3.38 FT. OF CONTINUOUS HEDGE  
 3.38 FT. OF CONTINUOUS HEDGE

**PLANT SCHEDULE BUFFER**

SYMBOL	BOTANICAL / COMMON NAME	SIZE	MIN. HT. / SPR	SPACING
○	EVERGREEN TREES	2" CAL.	4 FT.	16'-0" OC
▨	MULCH	MORDELLA GERBERA / ANA MORTUE		



EVERGREEN TREES: 10' OC  
 MULCH: 10" WIDE LANDSCAPE BUFFER (3.38 FT. OF PERMETER)

**GENERAL LANDSCAPE NOTES**

- CONTRACTOR IS REQUIRED TO PERFORM WEED CLEANING AND GRUBBING SERVICES FOR SCOPED AREAS PRIOR TO INSTALLING PLANT MATERIAL. THE INCLUDES BUT IS NOT LIMITED TO REMOVAL OF ALL EXISTING WEEDS AND GRASS. CONTRACTOR SHALL PROVIDE A WEEDING SCHEDULE TO THE OWNER. CONTRACTOR SHALL PROVIDE A WEEDING SCHEDULE TO THE OWNER. CONTRACTOR SHALL PROVIDE A WEEDING SCHEDULE TO THE OWNER.
- AREAS OF THE LAWNWAY CONTAIN CATCH BASINS AND AREA DRAINAGE. CONTRACTOR SHALL USE WEED BARRIERS AND MAINTAIN ESTHETIC VALUE. CONTACT LANDSCAPE ARCHITECT WITH ANY DISCREPANCIES.
- CONTRACTOR SHALL INSTALL ALL PLANT MATERIAL IN SIZE AS INDICATED IN THE PLANT SCHEDULE. CONTRACTOR SHALL MAINTAIN THE PLANT MATERIAL IN THE PLANT SCHEDULE. CONTRACTOR SHALL MAINTAIN THE PLANT MATERIAL IN THE PLANT SCHEDULE. CONTRACTOR SHALL MAINTAIN THE PLANT MATERIAL IN THE PLANT SCHEDULE.
- TREES LOCATED IN DRAINAGE WAYS TO BE FIELD ADJUSTED TO PLACE TREES OUTSIDE THE DRAINAGE WAY.
- CONTRACTOR WILL COORDINATE FLAGGING OF PROPERTY LINES, EASEMENT LINES, ETC. WITH OTHER LANDSCAPE ARCHITECT PRIOR TO INSTALLATION. ANY LOCATIONS ARE UNCLEAR OR APPEAR TO BE LOCATED ON PRIVATE LOTS OR ENCUMBRANCES.

**GENERAL LANDSCAPE NOTES**

- CONTRACTOR IS REQUIRED TO PERFORM WEED CLEANING AND GRUBBING SERVICES FOR SCOPED AREAS PRIOR TO INSTALLING PLANT MATERIAL. THE INCLUDES BUT IS NOT LIMITED TO REMOVAL OF ALL EXISTING WEEDS AND GRASS. CONTRACTOR SHALL PROVIDE A WEEDING SCHEDULE TO THE OWNER. CONTRACTOR SHALL PROVIDE A WEEDING SCHEDULE TO THE OWNER. CONTRACTOR SHALL PROVIDE A WEEDING SCHEDULE TO THE OWNER.
- AREAS OF THE LAWNWAY CONTAIN CATCH BASINS AND AREA DRAINAGE. CONTRACTOR SHALL USE WEED BARRIERS AND MAINTAIN ESTHETIC VALUE. CONTACT LANDSCAPE ARCHITECT WITH ANY DISCREPANCIES.
- CONTRACTOR SHALL INSTALL ALL PLANT MATERIAL IN SIZE AS INDICATED IN THE PLANT SCHEDULE. CONTRACTOR SHALL MAINTAIN THE PLANT MATERIAL IN THE PLANT SCHEDULE. CONTRACTOR SHALL MAINTAIN THE PLANT MATERIAL IN THE PLANT SCHEDULE. CONTRACTOR SHALL MAINTAIN THE PLANT MATERIAL IN THE PLANT SCHEDULE.
- TREES LOCATED IN DRAINAGE WAYS TO BE FIELD ADJUSTED TO PLACE TREES OUTSIDE THE DRAINAGE WAY.
- CONTRACTOR WILL COORDINATE FLAGGING OF PROPERTY LINES, EASEMENT LINES, ETC. WITH OTHER LANDSCAPE ARCHITECT PRIOR TO INSTALLATION. ANY LOCATIONS ARE UNCLEAR OR APPEAR TO BE LOCATED ON PRIVATE LOTS OR ENCUMBRANCES.

**GENERAL LANDSCAPE NOTES**

- CONTRACTOR IS REQUIRED TO PERFORM WEED CLEANING AND GRUBBING SERVICES FOR SCOPED AREAS PRIOR TO INSTALLING PLANT MATERIAL. THE INCLUDES BUT IS NOT LIMITED TO REMOVAL OF ALL EXISTING WEEDS AND GRASS. CONTRACTOR SHALL PROVIDE A WEEDING SCHEDULE TO THE OWNER. CONTRACTOR SHALL PROVIDE A WEEDING SCHEDULE TO THE OWNER. CONTRACTOR SHALL PROVIDE A WEEDING SCHEDULE TO THE OWNER.
- AREAS OF THE LAWNWAY CONTAIN CATCH BASINS AND AREA DRAINAGE. CONTRACTOR SHALL USE WEED BARRIERS AND MAINTAIN ESTHETIC VALUE. CONTACT LANDSCAPE ARCHITECT WITH ANY DISCREPANCIES.
- CONTRACTOR SHALL INSTALL ALL PLANT MATERIAL IN SIZE AS INDICATED IN THE PLANT SCHEDULE. CONTRACTOR SHALL MAINTAIN THE PLANT MATERIAL IN THE PLANT SCHEDULE. CONTRACTOR SHALL MAINTAIN THE PLANT MATERIAL IN THE PLANT SCHEDULE. CONTRACTOR SHALL MAINTAIN THE PLANT MATERIAL IN THE PLANT SCHEDULE.
- TREES LOCATED IN DRAINAGE WAYS TO BE FIELD ADJUSTED TO PLACE TREES OUTSIDE THE DRAINAGE WAY.
- CONTRACTOR WILL COORDINATE FLAGGING OF PROPERTY LINES, EASEMENT LINES, ETC. WITH OTHER LANDSCAPE ARCHITECT PRIOR TO INSTALLATION. ANY LOCATIONS ARE UNCLEAR OR APPEAR TO BE LOCATED ON PRIVATE LOTS OR ENCUMBRANCES.

**GENERAL LANDSCAPE NOTES**

- CONTRACTOR IS REQUIRED TO PERFORM WEED CLEANING AND GRUBBING SERVICES FOR SCOPED AREAS PRIOR TO INSTALLING PLANT MATERIAL. THE INCLUDES BUT IS NOT LIMITED TO REMOVAL OF ALL EXISTING WEEDS AND GRASS. CONTRACTOR SHALL PROVIDE A WEEDING SCHEDULE TO THE OWNER. CONTRACTOR SHALL PROVIDE A WEEDING SCHEDULE TO THE OWNER. CONTRACTOR SHALL PROVIDE A WEEDING SCHEDULE TO THE OWNER.
- AREAS OF THE LAWNWAY CONTAIN CATCH BASINS AND AREA DRAINAGE. CONTRACTOR SHALL USE WEED BARRIERS AND MAINTAIN ESTHETIC VALUE. CONTACT LANDSCAPE ARCHITECT WITH ANY DISCREPANCIES.
- CONTRACTOR SHALL INSTALL ALL PLANT MATERIAL IN SIZE AS INDICATED IN THE PLANT SCHEDULE. CONTRACTOR SHALL MAINTAIN THE PLANT MATERIAL IN THE PLANT SCHEDULE. CONTRACTOR SHALL MAINTAIN THE PLANT MATERIAL IN THE PLANT SCHEDULE. CONTRACTOR SHALL MAINTAIN THE PLANT MATERIAL IN THE PLANT SCHEDULE.
- TREES LOCATED IN DRAINAGE WAYS TO BE FIELD ADJUSTED TO PLACE TREES OUTSIDE THE DRAINAGE WAY.
- CONTRACTOR WILL COORDINATE FLAGGING OF PROPERTY LINES, EASEMENT LINES, ETC. WITH OTHER LANDSCAPE ARCHITECT PRIOR TO INSTALLATION. ANY LOCATIONS ARE UNCLEAR OR APPEAR TO BE LOCATED ON PRIVATE LOTS OR ENCUMBRANCES.

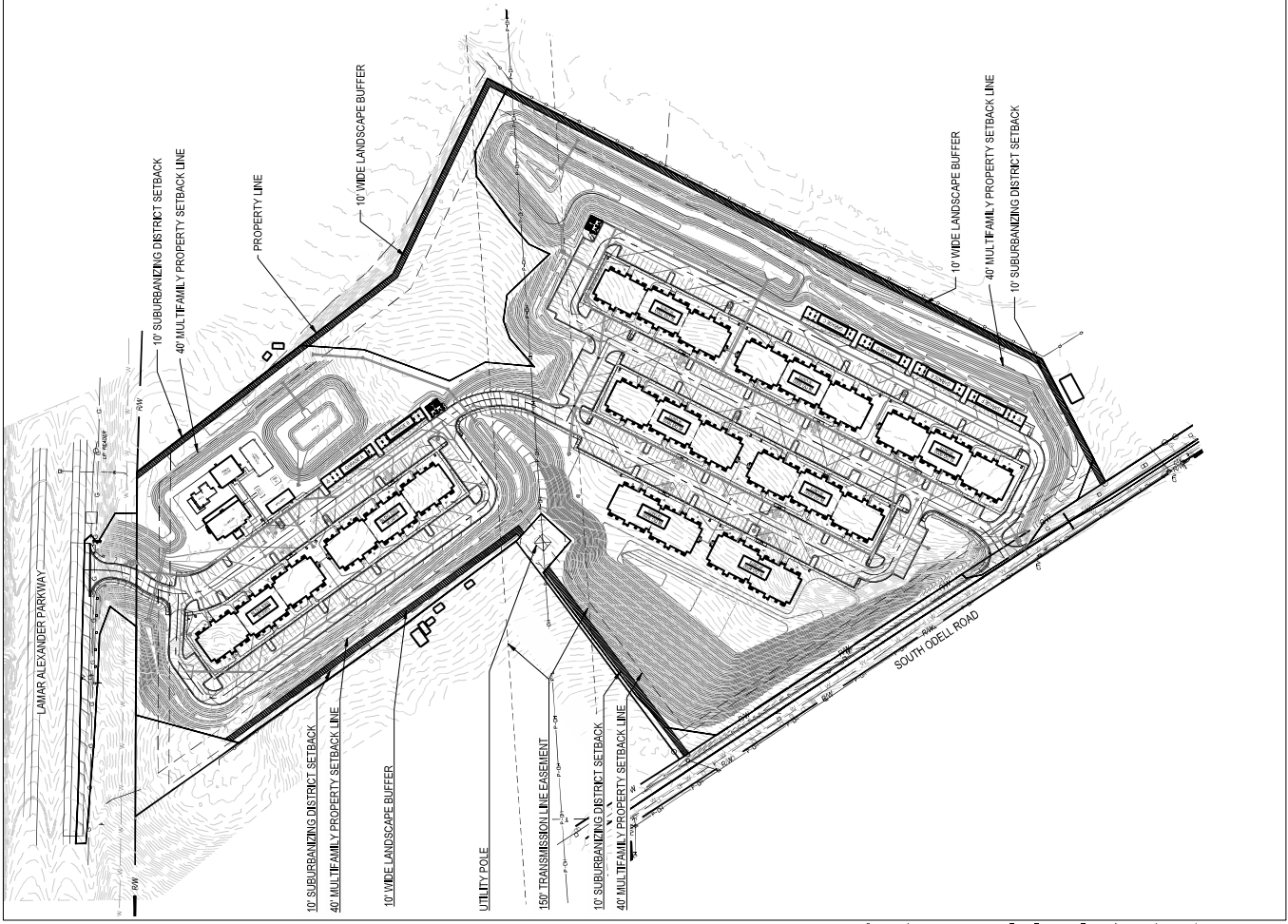

SCALE: 1"=100'-0"

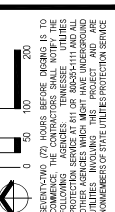

SEVENTY-TWO (72) HOURS BEFORE DIGGING IS TO BE REQUIRED FOR ALL UTILITY LOCATIONS IN THE FOLLOWING AREAS: TENNESSEE UTILITIES, TENNESSEE POWER AND LIGHT, TENNESSEE GAS, AND OTHER UTILITIES WHICH MOST TAKE UNDERGROUND UTILITY LOCATIONS. THE PROJECT AND ARE UTILITY LOCATIONS SHOULD BE IDENTIFIED AND NUMBERS OF STATE UTILITY PROTECTION SERVICE

